

**Offshore Supply,  
ROV Support,  
Emergency Response  
and Rescue**



**NORTH STAR  
SHIPPING**

A member of the **CRAIG** GROUP

> **Emergency Response and Rescue Vessel**

**Build Yard** > Denmark

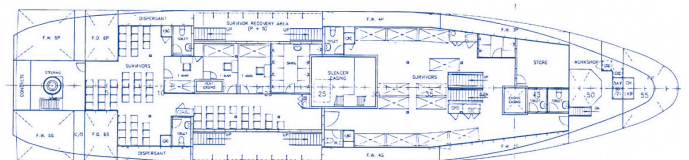
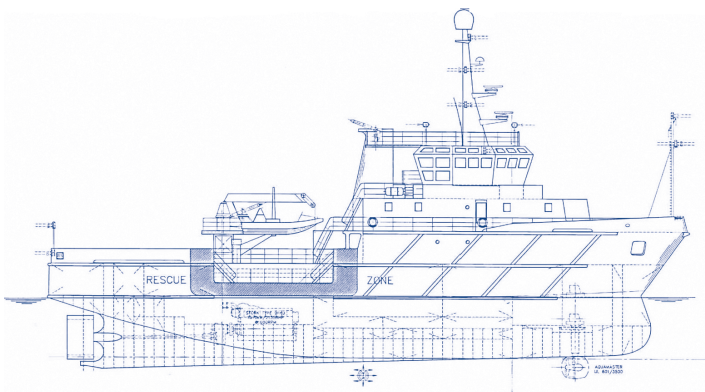

North Star Shipping (Aberdeen) Ltd  
12 Queens Road, Aberdeen AB15 4ZT

**T** +44 (0) 1224 261400  
**F** +44 (0) 1224 261401

**Flying the flag for Safety, Service and Quality**  
[www.craig-group.com/ourfleet](http://www.craig-group.com/ourfleet)

# Emergency Response and Rescue Vessel

## Specifications



### DIMENSIONS

LOA	47.00 metres
LBP	42.05 metres
Breadth Moulded	10.00 metres
Draft Loaded / Depth	4.90 metres

### TONNAGE

GRT	763 Tonnes
NRT	228 Tonnes
DWT	N/A Tonnes

### CAPACITIES AND CRANES

Fuel Oil (MGO) / Connection	180 m <sup>3</sup>
Fresh Water / Connection	200 m <sup>3</sup>
Ballast Water	Approx 250 m <sup>3</sup>
Oil Based Mud / Connection	N/A
Brine / Connection	N/A
DMA (Base Fluid) / Connection	N/A
Dry Bulk(s) / Connection	N/A
Deck Area	Approx 50 m <sup>2</sup> (Steel Deck)
Deck Loading	2.5 Tonnes per metre <sup>2</sup>
Deck Crane # 1	Hydralift extending Crane
Deck Crane # 2	N/A
Deck Crane # 3	N/A
Winch	N/A
Wire Reel	N/A
Deck Tuggers	N/A

### ENGINES/THRUSTERS/AUX

Main Engine(s)	1 x Wartsila @ 2135 BHP
Propeller(s)	1 x CPP
Bow Thruster(s)	1 x Aquamaster Azimuth @ 675 BHP
Bow Thruster(s)	NA
Stern Thruster(s)	NA
Aux Engines	3 x Cummins @ 250kW per unit
Shaft PTOs	1 x ME @ 350kW
Emergency Generators	

### CONTROL SYSTEMS AND DYNAMIC POSITIONING

Control Positions	Fwd & Aft consoles
Full Manual Control	Fwd & Aft consoles
Integrated Joystick Control	N/A
Joystick Control	N/A
Dynamic Positioning System	N/A
Fan Beam Laser	N/A
DGPS # 1	N/A
DGPS # 2	N/A
Hydro Acoustic Pos Ref # 1	N/A
Hydro Acoustic Pos Ref # 2	N/A
Vertical Taut Wire	N/A

### RESCUE AND EMERGENCY RESPONSE EQUIPMENT

Daughter Craft Davit # 1	N/A
Daughter Craft	N/A
Fast Rescue Craft Davit # 1	1 x Hydralift Heave Compensated System
Fast Rescue Craft	1 x 15 Man Seabear
Fast Rescue Craft Davit # 2	1 x Hydralift Heave Compensated System
Fast Rescue Craft	1 x 15 Man Seabear
Dacon Scoop	7 Metre Dacon Scoop
Dacon Rescue Crane	Hydralift extending Crane
Cosalt Rescue Basket	Fitted & Launched from aft deck
Jason Cradles Frames	Fitted
Winch Area	Located on Aft Main Deck
Emer. Towing Capability	Towing Hook Fitted
Dispersant Tanks	Fitted
Dispersant Spray Booms	Fully outfitted Port & Starboard
Searchlights	Fitted

### NAVIGATION AND COMMUNICATION EQUIPMENT

Radar(Fwd)	Furuno ARPA	Furuno 1505
Radar Rptr (Aft)		N/A
ECDIS		N/A
PLB System		N/A
DGPS(s)		Furuno
Gyro(s)		Sperry SR 50 Gyro
Autopilot		Robertson
Magnetic Comp		TG - Gillie 2000
Echo Sounder		Simrad ED 161
Digital Depth Recorder		N/A
Navtex		ICS Nav 5 Navtex
Sat Comms		Inmarsat A
MF/HF Radio		Sailor Compact
UHF		ICOM F410
VHF (Fwd)		Sailor 2048
VHF (Aft)		Sailor 2048
Helo Radio		ICOM IC A110
AIS		JRC
VHF Direction Finder		Taiyo TDL 1550
Doppler Log		N/A
SSAS		Furuno Felcom
Portable VHF		4 x NAVICO GMDSS
Portable VHF		6 x ENTEL VHF
Portable UHF		3 x ENTEL HT 880 UHF
Portable UHF		2 x Kenwood UHF
Sonic Helmets		4 x Sonic Helmets Mk 10
Smartpatch Phone		ICOM PS1

### CREW FACILITIES

Crew Cabins	12 Man Single Berth cabins
Recreation & Leisure	1 Messroom, 1 Lounge
Leisure	