

**Offshore Supply,  
ROV Support,  
Emergency Response  
and Rescue**



**NORTH STAR  
SHIPPING**

A member of the **CRAIG**GROUP

**IMT 960**



**Tanker Assist Class of Offshore Support Vessel**

**Build Yard** > Balenciaga, Spain

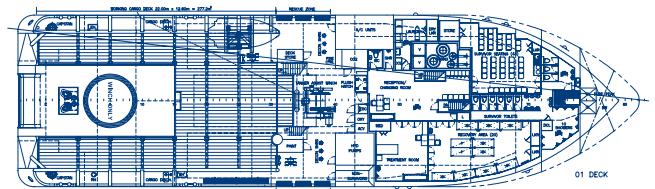
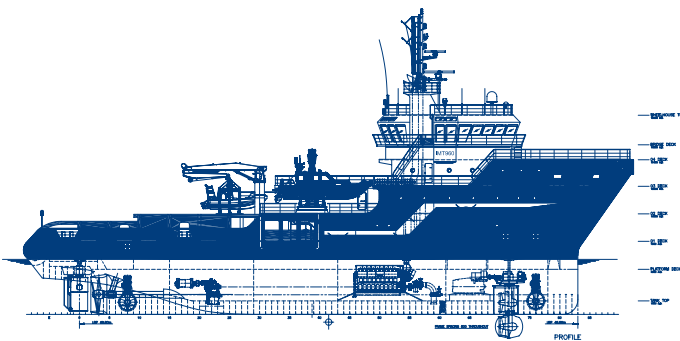

North Star Shipping (Aberdeen) Ltd  
12 Queens Road, Aberdeen AB15 4ZT

**T** +44 (0) 1224 261400  
**F** +44 (0) 1224 261401

**Flying the flag for Safety, Service and Quality**  
[www.craig-group.com](http://www.craig-group.com)

# IMT 960 Tanker Assist Class of Offshore Support Vessel

## Specifications >

### DIMENSIONS

LOA	60.00 metres
LBP	49.80 metres
Breadth Moulded	16.00 metres
Draft Loaded / Depth	6.2 metres / 7.3 metres

### TONNAGE

GRT	2113 Tonnes
NRT	633 Tonnes
DWT	1500 Tonnes

### CAPACITIES AND CRANES

Fuel Oil (MGO) / Connection	500 m <sup>3</sup> (approx)
Fresh Water / Connection	500 m <sup>3</sup> (approx)
Ballast Water	900 m <sup>3</sup> (approx)
Oil Recovery Tanks	Option
ROV Launch Platform	Option
Tanker Assistance	Option for Push Bow
Dry Bulk(s) / Connection	N/A
Deck Area	Approx 300 m <sup>2</sup> (Wood Sheathed Deck)
Deck Loading	5 Tonnes per metre
Deck Crane # 1	3T @ 11-16 metres
Deck Crane # 2	Hiab 2t @ 10m
Deck Crane # 3	Option
Bollard Pull	105 Tonnes
Winch	200t Double Waterfall
Wire Reel	N/A
Deck Tuggers	2 x 10 Tonnes

### ENGINES/THRUSTERS/AUX

Main Engine(s)	2 x Diesels @ 4050BHP per unit
Propeller(s)	2 x CPP
Azimuth Thruster(s)	Azimuth @ 750BHP (approx)
Bow Thruster(s)	Tunnel @ 750 BHP (approx)
Stern Thruster(s)	Tunnel @ 750 BHP (approx)
Rudder Systems / Type	2 x Hi-Lift Rudder
Aux Engines	3 x Auxiliaries Diesels
Shaft PTOs	2 x PTO from Main Engine
Emergency Generators	1 x Emer Genset

### CONTROL SYSTEMS AND DYNAMIC POSITIONING

Control Positions	Aft & Fwd consoles
Full Manual Control	Aft & Fwd consoles
Integrated Joystick Control	Poscon Joystick
Joystick Control	Aft
Dynamic Positioning System	Option
Fan Beam Laser	Option
DGPS # 1	Option
DGPS # 2	Option
Hydro Acoustic Pos Ref # 1	Option
Hydro Acoustic Pos Ref # 2	Option
Vertical Taut Wire	Option

### RESCUE AND EMERGENCY RESPONSE EQUIPMENT

Daughter Craft Davit # 1	Grampian Hydraulics Heave Compensated
Daughter Craft	Delta Phantom 10.25 metre (Diesel)
Daughter Craft Davit # 2	Grampian Hydraulics Heave Compensated
Daughter Craft	Delta Phantom 10.25 metre (Diesel)
Fast Rescue Craft Davit # 1	Grampian Hydraulics Heave Compensated
Fast Rescue Craft x 1	1 x Avon SR 6.4 15 Man (Petrol)
Dacon Scoop	5 Metre Dacon Scoop
Dacon Rescue Crane	Hiab 2t @ 10m
Cosalt Rescue Basket	Fitted & Launched from Fore or Aft Deck
Jason Cradles Frames	Fitted
Winch Area	Located on Aft Main Deck & Fore Deck
Emer. Towing Capability	200t Tow Winch fitted
Dispersant Tanks	2 x 5 Tonne Tanks below Main Deck
Dispersant Spray Booms	Fully outfitted Port & Starboard
Searchlights	4 x Wheelhouse mounted & remote operated
FIFI	FIFI 1 fitted

### NAVIGATION AND COMMUNICATION EQUIPMENT

Radar(s) (Fwd)	2 x ARPA
Radar (Aft)	1 x ARPA Slave
ECDIS	ECDIS System fitted
PLB System	Sea Marshall PLB fitted
DGPS(s)	DGPS
Gyro(s)	Gyro
Autopilot	Fitted
Magnetic Comp	Fitted
Echo Sounder	Fitted
Digital Depth Recorder	Fitted
Navtex	Fitted
Sat Comms	GMDSS A2 compliant
MF/HF Radio	Fitted
UHF	Fitted
VHF (Fwd)	Fitted
VHF (Aft)	Fitted
Helo Radio	Fitted
AIS	Fitted
VHF Direction Finder	Fitted
Doppler Log	Fitted
SSAS	Fitted
Portable VHF	Fitted
UHF Base	Fitted
Portable UHF	Fitted
Sonic Helmets	Fitted
Smartpatch Phone	Fitted

### CREW FACILITIES

Crew Cabins	15 Man Single Berth cabins c/w en suite facilities
Recreation & Leisure	1 Messroom, 2 Lounges, SAT TV
Leisure	1 x Ships Office