

**Offshore Supply,
ROV Support,
Emergency Response
and Rescue**



**NORTH STAR
SHIPPING**

A member of the **CRAIG**GROUP

IMT 950



Grampian D-Class Emergency Response and Rescue Vessel

Build Yard > Balenciaga, Spain

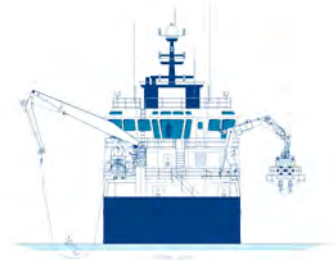
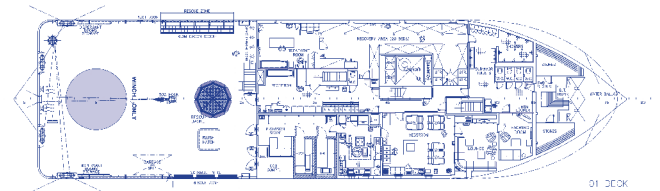
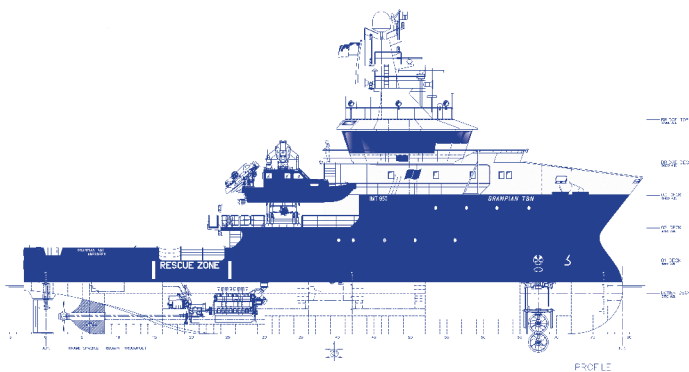

North Star Shipping (Aberdeen) Ltd
12 Queens Road, Aberdeen AB15 4ZT

T +44 (0) 1224 261400
F +44 (0) 1224 261401

Flying the flag for Safety, Service and Quality
www.craig-group.com/ourfleet

IMT 950 Grampian D-Class Emergency Response and Rescue Vessel

Specifications >

DIMENSIONS

| | |
|----------------------|------------------|
| LOA | 50.70 metres |
| LBP | 47.40 metres |
| Breadth Moulded | 13.00 metres |
| Draft Loaded / Depth | 4.3 / 6.0 metres |

TONNAGE

| | |
|-----|--------------|
| GRT | 1,330 Tonnes |
| NRT | 398 Tonnes |
| DWT | 690 Tonnes |

CAPACITIES AND CRANES

| | |
|-------------------------------|---------------------------------------|
| Fuel Oil (MGO) / Connection | 300 m ³ |
| Fresh Water / Connection | 150 m ³ |
| Ballast Water | Approx 350 m ³ |
| Oil Based Mud / Connection | N/A |
| Brine / Connection | N/A |
| DMA (Base Fluid) / Connection | N/A |
| Dry Bulk(s) / Connection | N/A |
| Deck Area | Approx 120m ² (Steel Deck) |
| Deck Loading | 3 Tonnes per metre ² |
| Deck Crane # 1 | Helia 1.5T @ 15 Metres (3t @ 10m) |
| Deck Crane # 2 | N/A |
| Deck Crane # 3 | N/A |
| Winch | Option – Buoy Recovery System fitted |
| Wire Reel | N/A |
| Deck Tuggers | N/A |

ENGINES/THRUSTERS/AUX

| | |
|-----------------------|--------------------------|
| Main Engine(s) | MAK 6M20 (2133 BHP) |
| Propeller(s) | 1 x CPP |
| Bow Thruster(s) | HRP Azimuth @ 500BHP |
| Stern Thruster(s) | N/A |
| Rudder Systems / Type | Fishtail HP Rudder |
| Aux Engines | 2 x Cat @ 547kW per unit |
| Shaft PTOs | 1 x PTO from Main Engine |
| Emergency Generators | 1 x Emer Genset @ 365 kW |

CONTROL SYSTEMS AND DYNAMIC POSITIONING

| | |
|-----------------------------|----------------------------------|
| Control Positions | Fwd, Aft, Port and Stbd consoles |
| Full Manual Control | Fwd and Aft consoles |
| Integrated Joystick Control | Converteam Joystick System |
| Joystick Control | Aft, Port and Starboard consoles |
| Dynamic Positioning System | N/A |
| Fan Beam Laser | N/A |
| DGPS # 1 | N/A |
| DGPS # 2 | N/A |
| Hydro Acoustic Pos Ref # 1 | N/A |
| Hydro Acoustic Pos Ref # 2 | N/A |
| Vertical Taut Wire | N/A |

RESCUE AND EMERGENCY RESPONSE EQUIPMENT

| | |
|-----------------------------|----------------------------------------|
| Daughter Craft Davit # 1 | NED DECK MARINE Heave Compensated |
| Daughter Craft | Delta Phantom 10.25 metre (Diesel) |
| Daughter Craft Davit # 2 | Option |
| Daughter Craft | Option |
| Fast Rescue Craft Davit # 1 | NED DECK MARINE Heave Compensated |
| Fast Rescue Craft | 1 x Avon SR 6.4 15 Man (Petrol) |
| Dacon Scoop | Dacon Scoop fitted |
| Dacon Rescue Crane | Heila Telescopic Boom crane 1.5t @ 15m |
| Cosalt Rescue Basket | Fitted and launched from Aft deck |
| Jason Cradles Frames | Fitted |
| Winch Area | Located on Aft Main Deck |
| Emer. Towing Capability | Towing Hook Fitted |
| Dispersant Tanks | 2 x 5 Tonne Tanks below Main Deck |
| Dispersant Spray Booms | Fully outfitted Port and Starboard |
| Searchlights | 4 x IBAK Kiel Fwd, Port, Stbd and Aft |

NAVIGATION AND COMMUNICATION EQUIPMENT

| | | |
|------------------------|-----------------------------------------|--------------------------|
| Radar (Fwd) | Furuno 2817 ARPA | Furuno 2837 ARPA |
| Radar Rprtr (Aft) | | Hatteland |
| ECDIS | | Option – Microplot ECDIS |
| PLB System | | N/A |
| DGPS(s) | | Furuno DGPS 90 |
| Gyro(s) | | Anschutz S22 Gyro |
| Autopilot | | Anschutz NP 60 |
| Magnetic Comp | | Gillie 2000 |
| Echo Sounder | | FE 700 ES |
| Digital Depth Recorder | | FE 720 |
| Navtex | | Furuno NX 700 Navtex |
| Sat Comms | Inmarsat C Felcon, Fleet 77 CapSat (A3) | |
| MF/HF Radio | | Furuno FS 2570 C (A3) |
| UHF | | 3 x UHF Units |
| VHF (Fwd) | FM8800 GMDSS VHF, ICOM ICM 401E | |
| VHF (Aft) | FM8800 GMDSS VHF, ICOM ICM 401E | |
| Helo Radio | | ICOM IC A110 |
| AIS | | Jotrun AIS TR 2500 |
| VHF Direction Finder | | Taiyo TDL 1550 |
| Doppler Log | | Furuno DS 80 |
| SSAS | | Furuno Felcom |
| Portable VHF | | 3 x Jotrun GMDSS |
| Portable VHF | | 6 x ENTEL HT 640 VHF |
| Portable UHF | | 3 x ENTEL HT 880 UHF |
| Portable UHF | | 2 x Kenwood UHF |
| Sonic Helmets | | 4 x Sonic Helmets Mk 10 |
| Smartpatch Phone | | ICOM PS1 |

CREW FACILITIES

| | |
|----------------------|----------------------------------------------------|
| Crew Cabins | 15 Man Single Berth cabins c/w en suite facilities |
| Recreation & Leisure | 1 Messroom, 2 Lounges |
| Leisure | 1 x Sauna, 1 x Gym, 1 x Ship's Office |