

**Offshore Supply,
ROV Support,
Emergency Response
and Rescue**



**NORTH STAR
SHIPPING**

A member of the **CRAIG**GROUP

IMT 948



C-Class Emergency Response and Rescue Vessel (Twin Daughter Craft)

Build Yard > Balenciaga, Spain

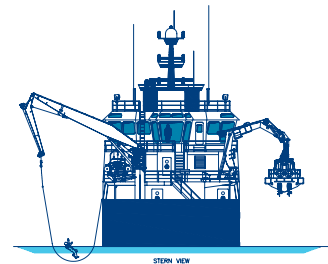
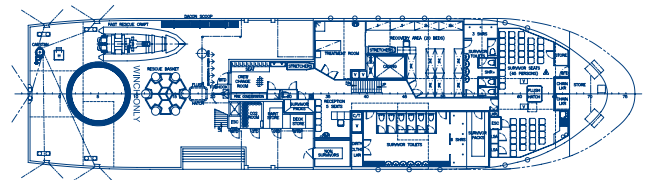
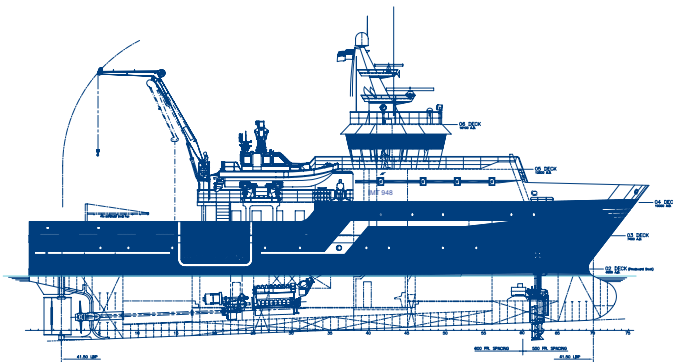

North Star Shipping (Aberdeen) Ltd
12 Queens Road, Aberdeen AB15 4ZT

T +44 (0) 1224 261400
F +44 (0) 1224 261401

Flying the flag for Safety, Service and Quality
www.craig-group.com/ourfleet

IMT 948 C-Class Emergency Response and Rescue Vessel (Twin Daughter Craft)

Specifications >

DIMENSIONS

LOA	48.25 metres
LBP	40.50 metres
Breadth Moulded	11.8 metres
Draft Loaded / Depth	5.65 metres / 7.4 metres

TONNAGE

GRT	1130 Tonnes
NRT	339 Tonnes
DWT	465 Tonnes

CAPACITIES AND CRANES

Fuel Oil (MGO) / Connection	298 m ³
Fresh Water / Connection	171 m ³
Ballast Water	Approx 350 m ³
Oil Based Mud / Connection	N/A
Brine / Connection	N/A
DMA (Base Fluid) / Connection	N/A
Dry Bulk(s) / Connection	N/A
Deck Area	Approx 120 m ² (Steel Deck)
Deck Loading	3 Tonnes per metre ²
Deck Crane # 1	Dreggen DKF 40 2T @ 15 metres
Deck Crane # 2	N/A
Deck Crane # 3	N/A
Winch	N/A
Wire Reel	N/A
Deck Tuggers	N/A

ENGINES/THRUSTERS/AUX

Main Engine(s)	MAK 2050 BHP
Propeller(s)	1 x CPP
Bow Thruster(s)	Schottel Azimuth @ 400BHP
Stern Thruster(s)	N/A
Rudder Systems / Type	Schilling Fishtail HP Rudder
Aux Engines	2 x Volvo @ 270kW per unit
Shaft PTOs	1 x PTO from Main Engine
Emergency Generators	1 x Emer Genset @ 150 kW

CONTROL SYSTEMS AND DYNAMIC POSITIONING

Control Positions	Fwd, Aft, Port & Stbd consoles
Full Manual Control	Fwd & Aft consoles
Integrated Joystick Control	Schottel Masterstick
Joystick Control	Aft, Port and Starboard consoles
Dynamic Positioning System	N/A
Fan Beam Laser	N/A
DGPS # 1	N/A
DGPS # 2	N/A
Hydro Acoustic Pos Ref # 1	N/A
Hydro Acoustic Pos Ref # 2	N/A
Vertical Taut Wire	N/A

RESCUE AND EMERGENCY RESPONSE EQUIPMENT

Daughter Craft Davit	2 x Grampian Hydraulics Heave Compensated
Daughter Craft	2 x Delta Phantom 10.25 metre (Diesel)
Fast Rescue Craft Davit # 1	Grampian Hydraulics Heave Compensated
Fast Rescue Craft	Avon SR 6.4 15 Man (Petrol)
Dacon Scoop	7 Metre Dacon Scoop
Dacon Rescue Crane	Dreggen DKF 40 Knuckle Boom 2t @ 15m
Cosalt Rescue Basket	Fitted & Launched from aft deck
Jason Cradles Frames	Fitted
Winch Area	Located on Aft Main Deck
Emer. Towing Capability	Towing Hook Fitted
Dispersant Tanks	2 x 5 Tonne Tanks below Main Deck
Dispersant Spray Booms	Fully outfitted Port & Starboard
Searchlights	4 x IBAK Kiel Fwd, Port, Stbd & Aft

NAVIGATION AND COMMUNICATION EQUIPMENT

Radar(Fwd)	1 x Furuno 2817 ARPA	1 x Furuno 2837 ARPA
Radar Rptr (Aft)		Hatteland
ECDIS		Micro-Plot ECDIS System
PLB System		N/A
DGPS(s)		Furuno DGPS 90
Gyro(s)		Anschutz S22 Gyro
Autopilot		Anschutz NP 60
Magnetic Comp		Gillie 2000
Echo Sounder		FE 700 ES
Digital Depth Recorder		FE 720
Navtex		Furuno NX 700 Navtex
Sat Comms	Inmarsat C Felcon, Fleet 77 CapSat (A3)	
MF/HF Radio		Furuno FS 2570 C (A3)
UHF		3 x UHF Units
VHF (Fwd)	FM8800 GMDSS VHF, ICOM ICM 401E	
VHF (Aft)	FM8800 GMDSS VHF, ICOM ICM 401E	
Helo Radio		ICOM IC A110
AIS		Jotrun AIS TR 2500
VHF Direction Finder		Taiyo TDL 1550
Doppler Log		Furuno DS 80
SSAS		Furuno Felcom
Portable VHF		3 x Jotrun GMDSS
Portable VHF		6 x ENTEL HT 640 VHF
Portable UHF		3 x ENTEL HT 880 UHF
Portable UHF		2 x Kenwood UHF
Sonic Helmets		4 x Sonic Helmets Mk 10
Smartpatch Phone		ICOM PS1

CREW FACILITIES

Crew Cabins	15 Man Single Berth cabins c/w en suite facilities
Recreation & Leisure	1 Messroom, 2 Lounges
Leisure	1 x Sauna, 1 x Gym, 1 x Ship's Office